

# Installation Manual

VOLVO V90 EST  
VOL-V90-E-A



## COMPONENTS INCLUDED

## SHADES

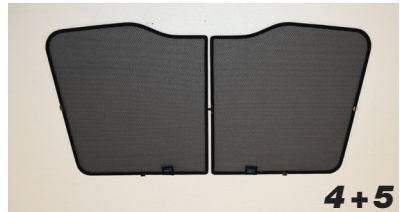
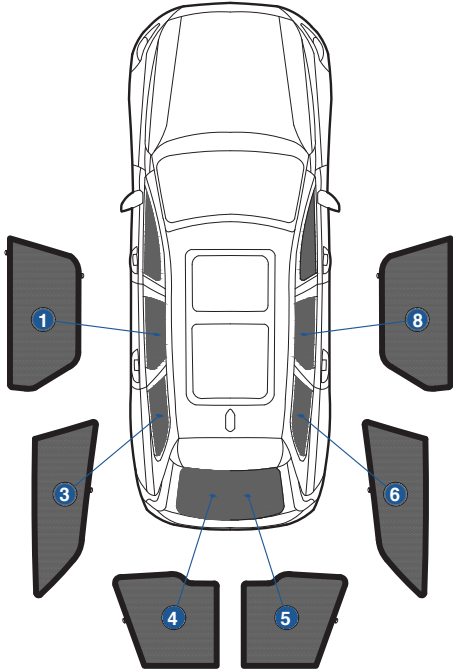

## FIXING CLIPS



CL-M02 x 10



CL-M12 x 2



CL-M13 x 2



CL-M14 x 1

# Side Shade Installation

VOLVO V90 EST  
VOL-V90-E-A

## COMPONENTS NEEDED:



### STEP #1 ATTACH CLIPS ON SHADE EDGES

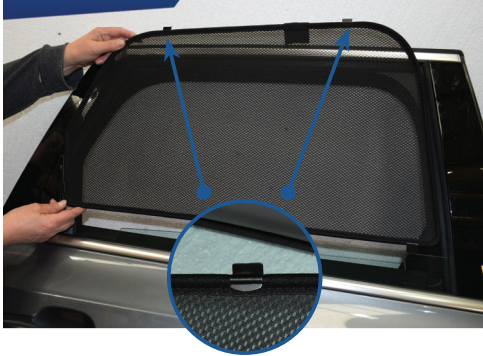

### STEP #2 POSITION THE SIDE SHADE

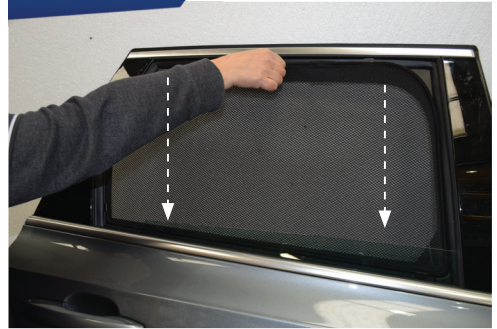

### STEP #3 INSERT CLIPS INSIDE WEATHERSTRIP

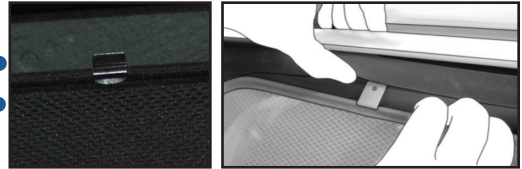

### STEP #4 ENSURE SECURELY FITTED IN PLACE

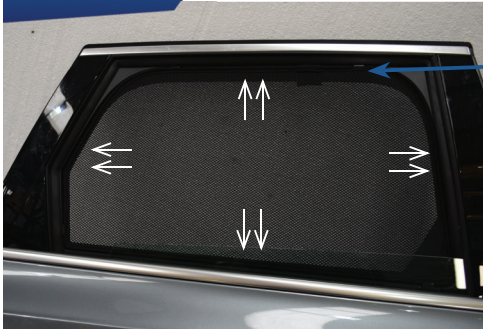

# Quarter Light Shade Installation

VOLVO V90 EST  
VOL-V90-E-A

## COMPONENTS NEEDED:



### STEP #1

ATTACH CLIPS ON SHADE EDGES



### STEP #2

INSERT CLIPS BEHIND INTERIOR TRIM



### STEP #3

ENSURE SECURELY FITTED IN PLACE



**CAR**<sup>®</sup>  
SHADES

# Rear Shade Installation

VOLVO V90 EST  
VOL-V90-E-A

## COMPONENTS NEEDED:

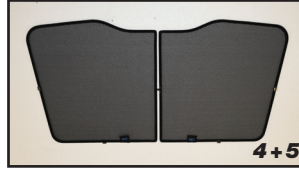

CL-M02 x 4



CL-M14 x 1

### STEP #1

ATTACH CLIPS ON SHADE EDGES



### STEP #2

POSITION THE REAR SHADE

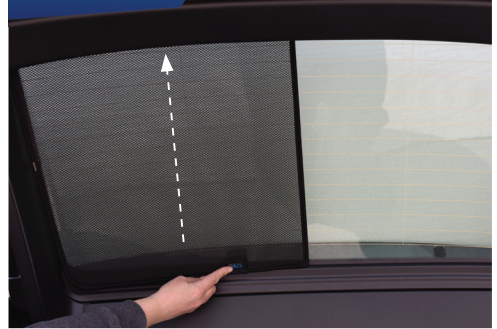

### STEP #3

INSERT CLIPS BEHIND INTERIOR TRIM



### STEP #4

REPEAT THE PROCESS ON OTHER SHADE

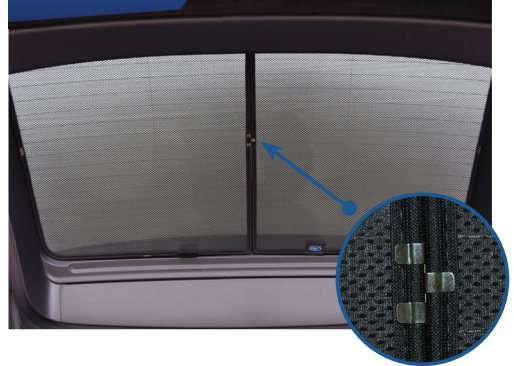

### STEP #5

ENSURE SECURELY FITTED IN PLACE

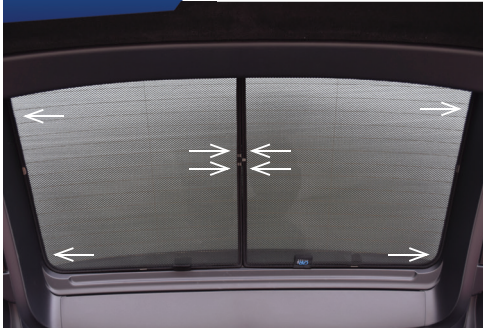

**CAR**<sup>®</sup>  
SHADES