

Installation Manual

BMW 7 SERIES 4DR
BMW-7SER-4-D-18



COMPONENTS INCLUDED



FIXING CLIPS



CL-M13 x 4



CL-M04 x 2



CL-M02 x 4



Side Shade (A) Installation

BMW 7 SERIES 4DR
BMW-7SER-4-D-18

COMPONENTS NEEDED:

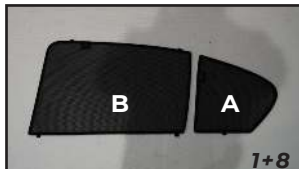

STEP #1

ATTACH CLIPS ON SHADE EDGES



STEP #2

POSITION THE SIDE SHADE



STEP #3

ATTACH SIDE SHADE BEHIND CLIPS



STEP #4

ENSURE SECURELY FITTED IN PLACE



CAR
SHADES

Side Shade (B) Installation

BMW 7 SERIES 4DR
BMW-7SER-4-D-18

COMPONENTS NEEDED:

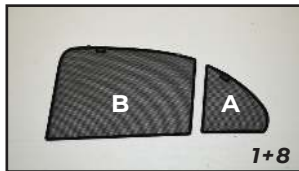

CL-M02 x 2



CL-M13 x 2

STEP #1

ATTACH CLIPS ON SHADE EDGES

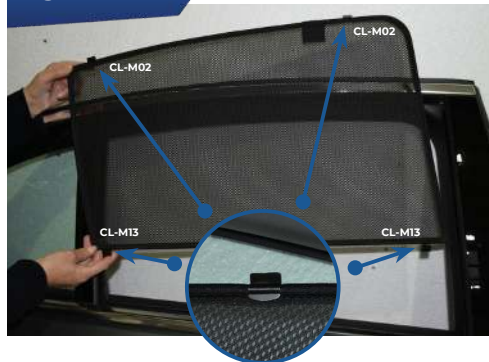

STEP #2

POSITION THE SIDE SHADE

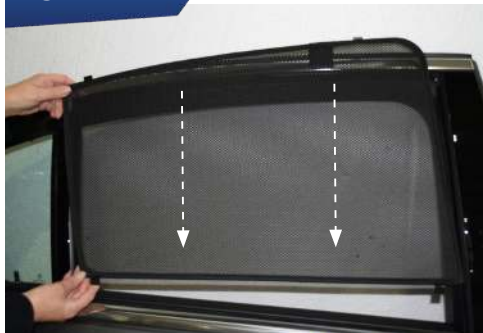

STEP #3

ATTACH SIDE SHADE BEHIND CLIPS



STEP #4

ENSURE SECURELY FITTED IN PLACE

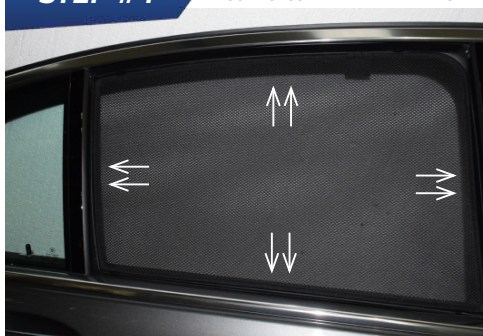

CAR
SHADES